

max. zul. Drehmoment $T_{k \max} = 770000 \text{ Nm}$
 MAX. PERMISSIBLE TORQUE
 max. zul. Radialkraft $F_{r \max} = 475000 \text{ N}$
 MAX. PERMISSIBLE RADIAL LOAD

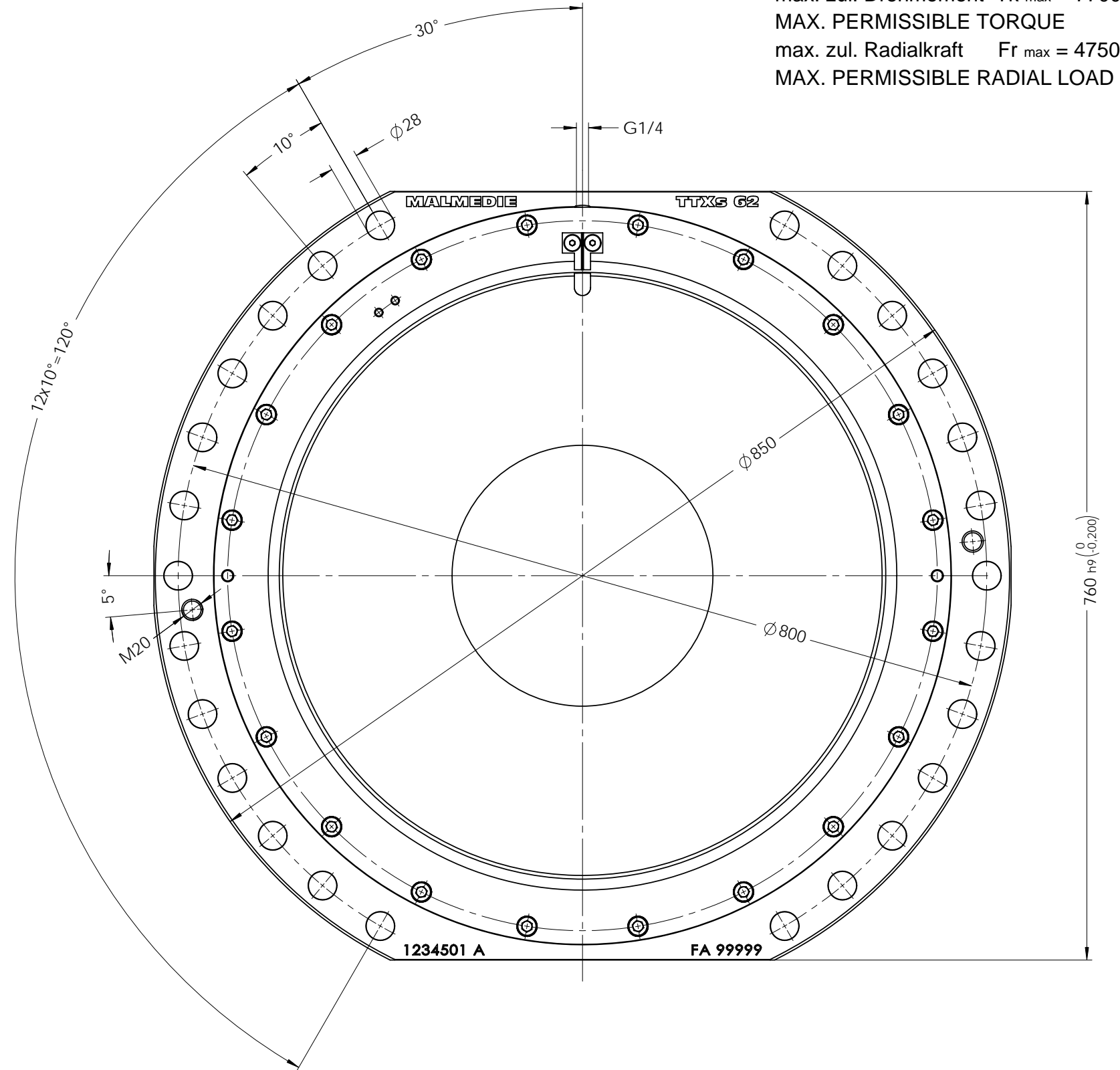
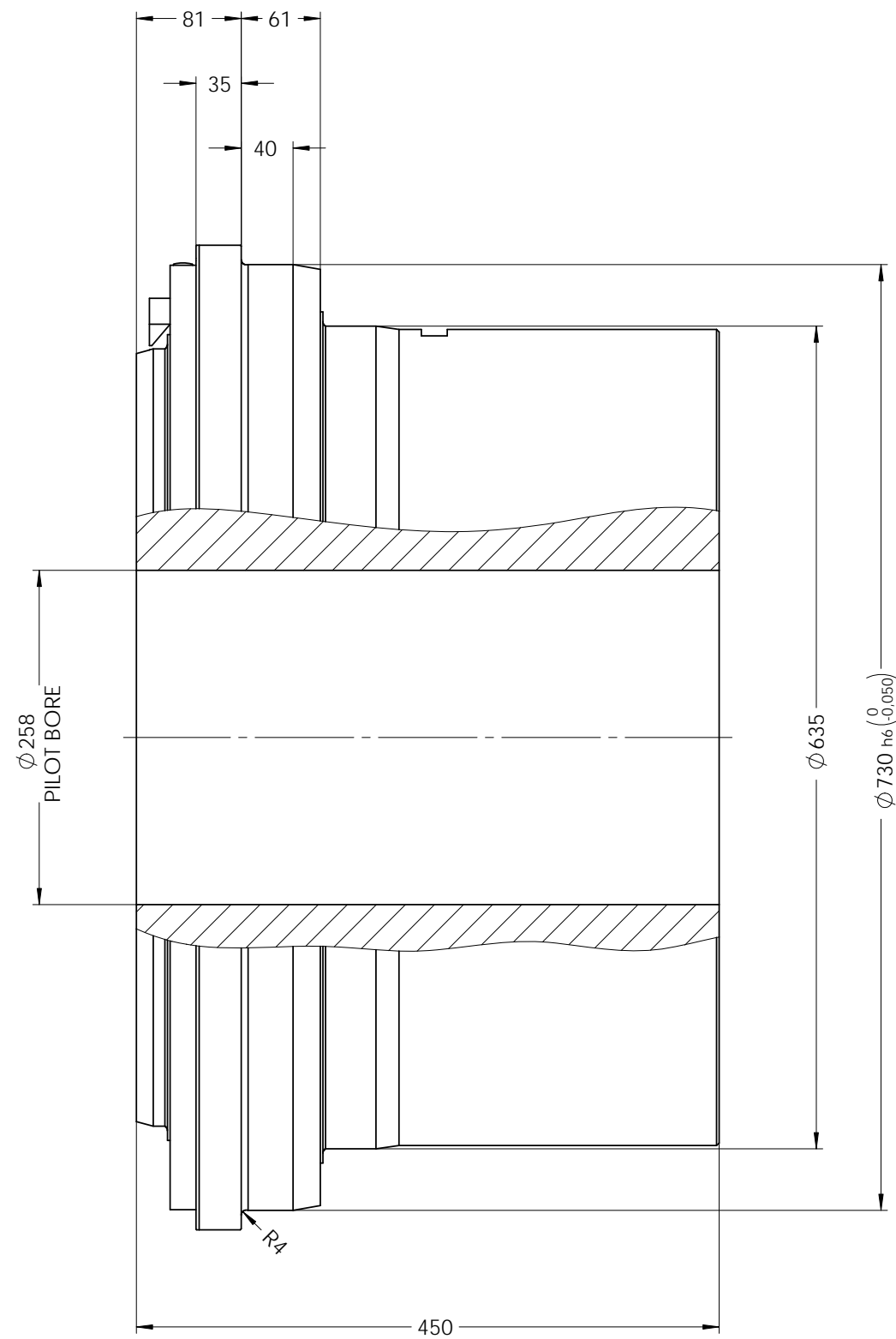

Oberflächen nach DIN ISO 1302 Indication of surfaces to DIN ISO 1302 Werkstückkanten DIN6784 Edges of working parts DIN6784 	 Dycker Feld 28 42653 Solingen Phone: +49 (0) 212 / 258 11 - 0 Email: info@malmedie.com Internet: http://www.malmedie.com	Werkstoff / Material		Gewicht / Weight ca.																								
		Zugfestigkeit - - - N/mm ²		1038.31 kg																								
Allgemeintoleranzen nach ISO 2768-mH General tolerances to ISO 2768-mH Schutzvermerk DIN 34 beachten Interlectual property rights according to DIN34	Tonnenkupplung / DRUM COUPLING	Mindeststreckgrenze - N/mm ²		Mass moment of inertia																								
		62		68.51 kgm ²																								
Benennung / Designation		Ausführung / Type																										
		TTXs																										
<table border="1"> <thead> <tr> <th>Datum / Date</th> <th>Name</th> <th>Format Size</th> <th>Zeichnungs-Nr. / Drawing-No.</th> <th>And. Index</th> </tr> </thead> <tbody> <tr> <td>01.09.2009</td> <td>Zimmerle</td> <td>A3</td> <td>656018</td> <td>A</td> </tr> <tr> <td>-</td> <td>-</td> <td>-</td> <td>-</td> <td>-</td> </tr> </tbody> </table>		Datum / Date	Name	Format Size	Zeichnungs-Nr. / Drawing-No.	And. Index	01.09.2009	Zimmerle	A3	656018	A	-	-	-	-	-	<table border="1"> <thead> <tr> <th>Ursprung / Origin</th> <th>Norm / Stand</th> <th>Maßstab / Scale</th> <th>1:5</th> <th>Projection ISO 128</th> </tr> </thead> <tbody> <tr> <td>-</td> <td>-</td> <td>1 / 1</td> <td>1:5</td> <td></td> </tr> </tbody> </table>		Ursprung / Origin	Norm / Stand	Maßstab / Scale	1:5	Projection ISO 128	-	-	1 / 1	1:5	
Datum / Date	Name	Format Size	Zeichnungs-Nr. / Drawing-No.	And. Index																								
01.09.2009	Zimmerle	A3	656018	A																								
-	-	-	-	-																								
Ursprung / Origin	Norm / Stand	Maßstab / Scale	1:5	Projection ISO 128																								
-	-	1 / 1	1:5																									