

max. zul. Drehmoment  $T_{k \max} = 41000 \text{ Nm}$   
 MAX. PERMISSIBLE TORQUE  
 max. zul. Radialkraft  $F_{r \max} = 53000 \text{ N}$   
 MAX. PERMISSIBLE RADIAL LOAD

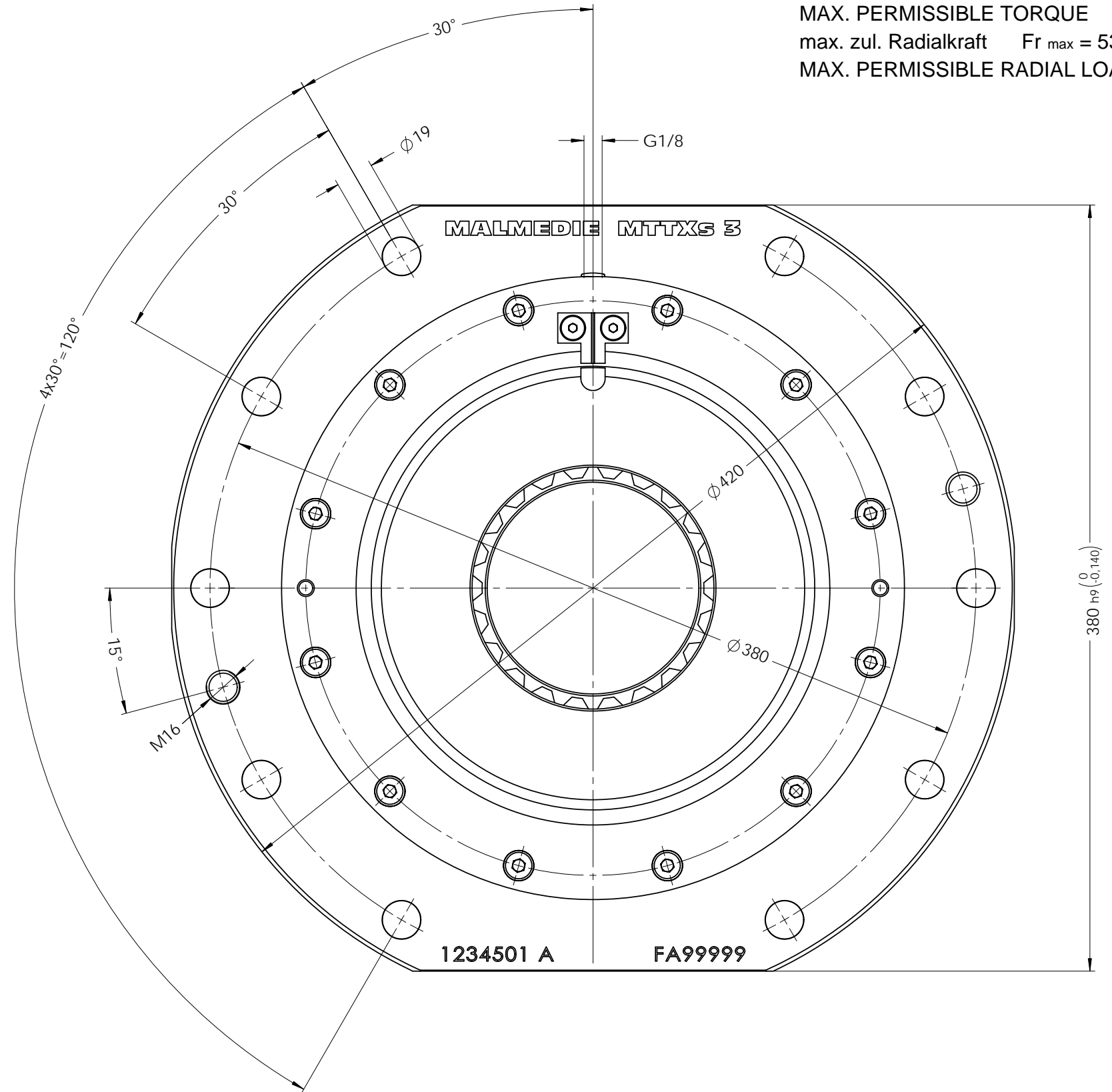
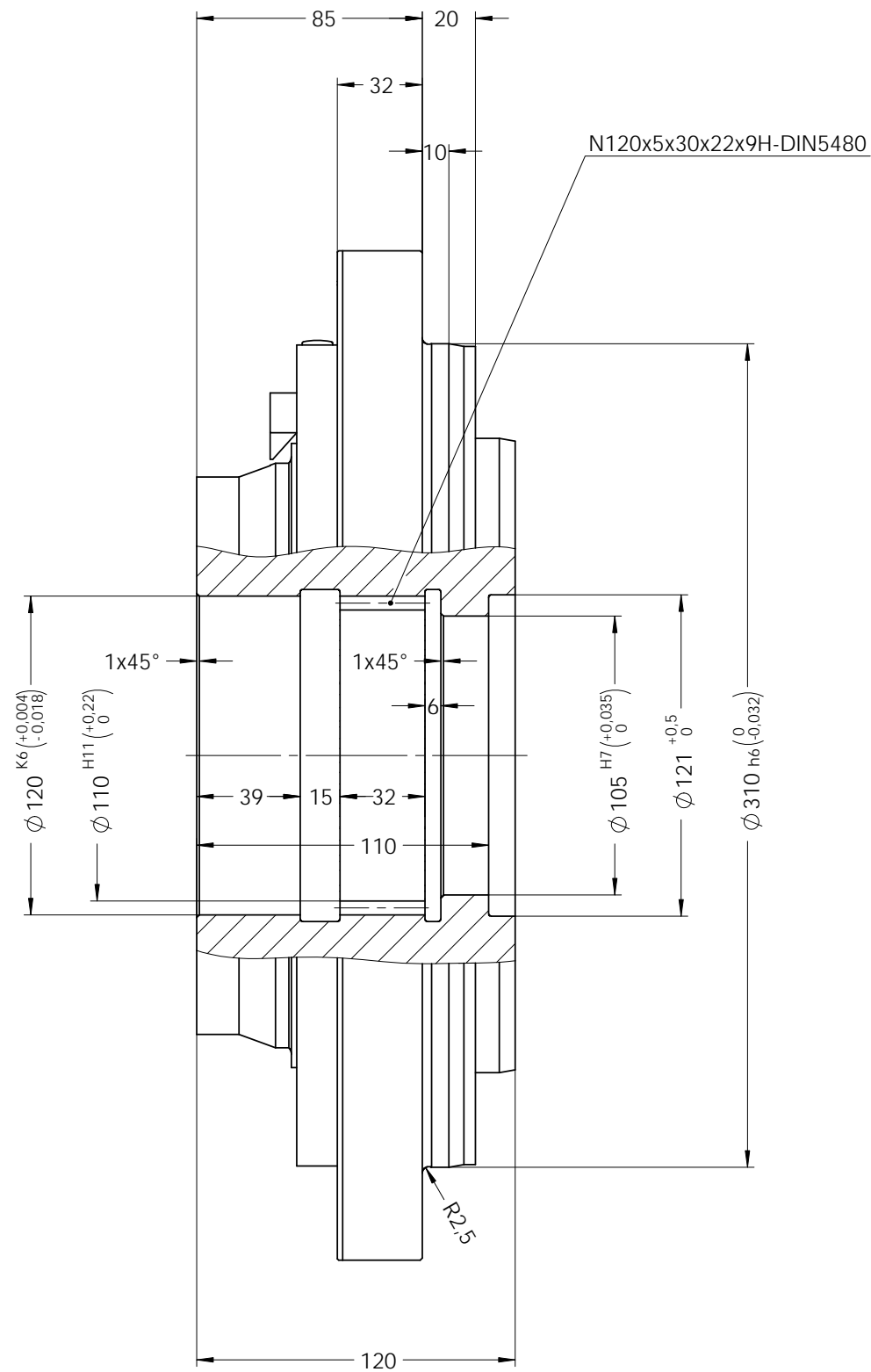

|                                                                                                                                          |                                                                                                                                       |                                         |          |                        |                              |                    |
|------------------------------------------------------------------------------------------------------------------------------------------|---------------------------------------------------------------------------------------------------------------------------------------|-----------------------------------------|----------|------------------------|------------------------------|--------------------|
| Oberflächen nach DIN ISO 1302<br>Indication of surfaces to DIN ISO 1302<br>Werkstückkanten DIN6784<br>Edges of working parts DIN6784<br> | <br>Dycker Feld 28 42653 Solingen<br>Phone: +49 (0) 212 / 258 11 - 0<br>Email: info@malmedie.com<br>Internet: http://www.malmedie.com | Werkstoff / Material                    |          | Gewicht / Weight ca.   |                              |                    |
|                                                                                                                                          |                                                                                                                                       | Zugfestigkeit - - - N/mm <sup>2</sup>   |          | 59.18 kg               |                              |                    |
| Allgemeintoleranzen nach ISO 2768-mH<br>General tolerances to ISO 2768-mH                                                                |                                                                                                                                       | Mindeststreckgrenze - N/mm <sup>2</sup> |          | Mass moment of inertia |                              |                    |
| Schutzvermerk DIN 34 beachten<br>Interlectual property rights<br>according to DIN34                                                      |                                                                                                                                       | 3                                       |          | 1.02 kgm <sup>2</sup>  |                              |                    |
| Benennung / Designation                                                                                                                  |                                                                                                                                       | Ausführung / Type                       |          | MTTXs                  |                              |                    |
| Tonnenkupplung / DRUM COUPLING                                                                                                           |                                                                                                                                       | 3                                       |          | MTTXs                  |                              |                    |
| Ersatz für Supersedes -                                                                                                                  |                                                                                                                                       | Datum / Date                            | Name     | Format Size            | Zeichnungs-Nr. / Drawing-No. | And. Index         |
| Ersatz durch Superseded by -                                                                                                             |                                                                                                                                       | 20.09.2016                              | Zimmerle | A3                     | 657122                       | A                  |
| Ersatz durch Superseded by -                                                                                                             |                                                                                                                                       | -                                       | -        | 1 / 1                  | Maßstab Scale 1:2            | Projection ISO 128 |
| Ersatz durch Superseded by -                                                                                                             |                                                                                                                                       | -                                       | -        | -                      | -                            | -                  |